

LWD 12 Ü

Double Wall-mounted Loudspeaker



Main features

- Robust industrial technology
- Sturdy and robust design
- Easy mounting
- Ingress protection IP 40
- Ideal for use in indoor areas
- Suitable for speech and background music

The compact wall-mounted loudspeakers of the LWD 12 Ü series are used together with the INDUSTRONIC communication and public address system. They are ideal for use in indoor areas, e.g. corridors.

Mechanical data

• Housing	Plastic
• Dimensions (Width x Height x Depth)	191 mm x 157 mm x 169 mm (7 1/2" x 6" x 6 1/2")
• Ingress protection	IP 40
• Weight	2.0 kg (4 lb)
• Connection	Clamp
• Color	White RAL 9016

Electrical data

• Rated power	12 W
• Transformer tapplings	100 V: 12 W / 6 W / 3 W
• Sound pressure level 1 W, 1 m	89 dB
• Sound pressure level 12 W, 1 m	100 dB
• Effective frequency range	120 Hz to 20000 Hz
• Dispersion angle -6 dB	1 kHz: 160°, 4 kHz: 120° 8 kHz: 50°

Frequency diagram

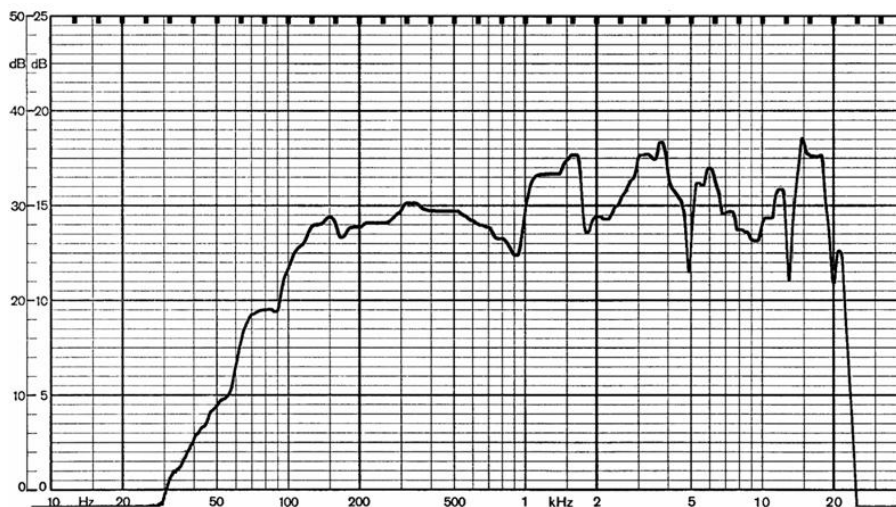

Measurement conditions

Sound pressure level (SPL): 1 W / 1 m

Pink noise: 1/3 octave filter

Zero level: 60 dB

Range: 50 dB

Output level related to distance

P _{max} : 12 W	Level (dB) at	(-6 dB)	(-12 dB)	(-16 dB)	(-18 dB)	(-22 dB)	(-24 dB)	(-26 dB)	(-28 dB)
	1 m	2 m	4 m	6 m	8 m	12 m	16 m	20 ,	25 m
	100	94	88	84	82	78	76	74	72

Polar diagram

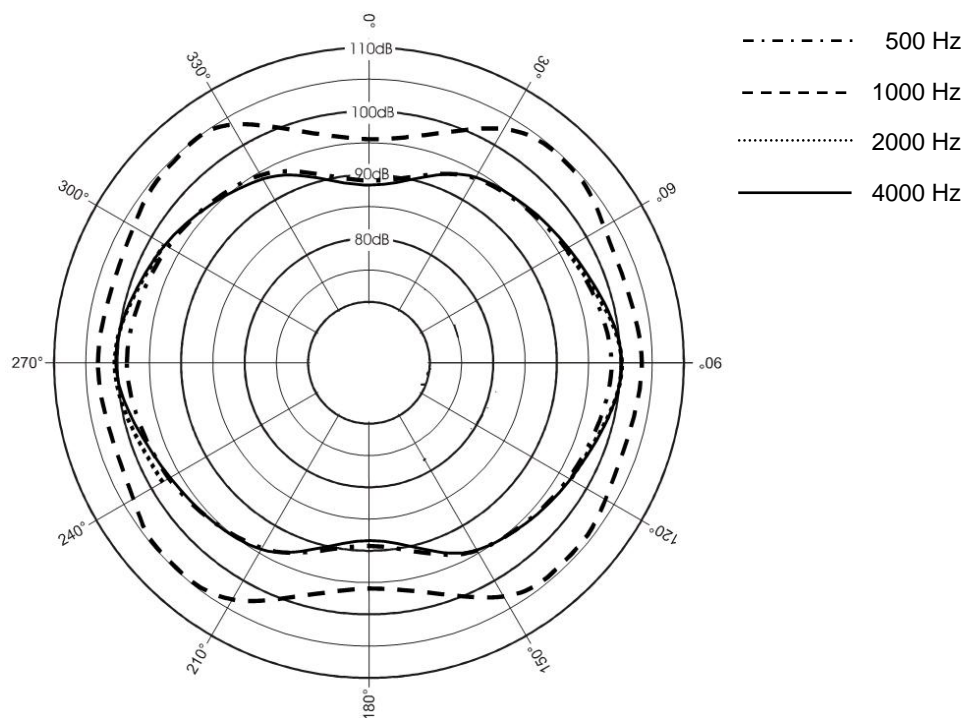

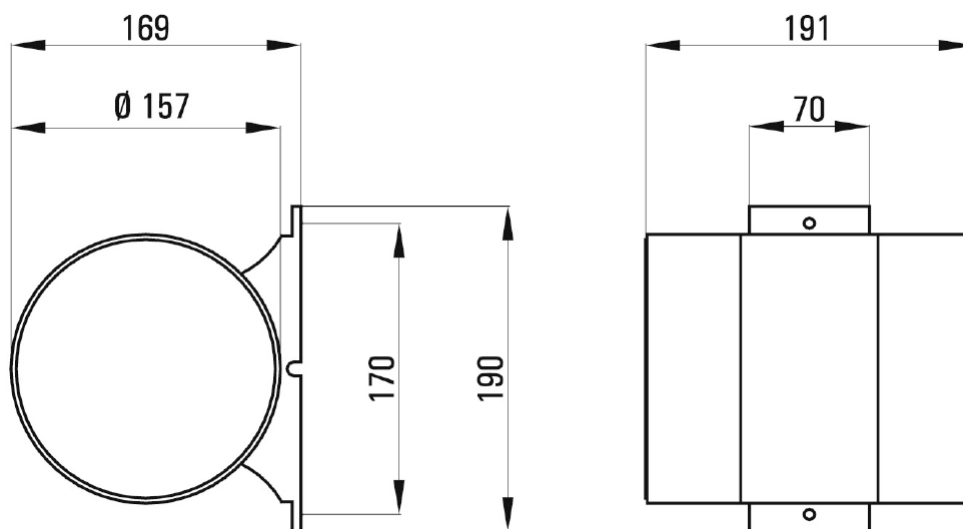

Figure 1: Dimensional drawing LWD 12 Ü

INDUSTRONIC®

Industrie-Electronic GmbH & Co. KG
 Carl-Jacob-Kolb-Weg 1
 97877 Wertheim / Germany

Tel.: +49 9342 871-0
 Fax: +49 9342 871-517

info@industronic.de
 www.industronic.com